

Rescue Tools

1ST CHOICE
FOR OVER 50 YRS

WORLD'S
LEADING
RESCUE
TOOLS



holmatro
mastering power

INCLINED CUTTING

THE 30° REVOLUTION

Inclined Cutting is a revolutionary, new cutting technique. With its unique 30-degree angled jaw, the Holmatro Inclined Cutter improves user comfort and maximizes working space.



Improved ergonomics

The Holmatro Inclined Cutter reduces physical strain when cutting vehicles well above or below waist level. You don't need to lift the cutter to shoulder level for a high cut or to bend over for a low cut. The inclined jaw keeps the ideal 90° angle towards the construction, required for effective cutting. Any other position will reduce cutting performance.



Maximized working space

With the Holmatro Inclined Cutter you can work more quickly and safely, thanks to 30 degrees of extra working space for your tool. It enhances patient safety and minimizes the need for repeated cutter repositioning.



NCT cutters - Inclined

NCT = New Car Technology



CU 5030 i CL

Specifications	CU 5030 i CL	CU 5040 i	CU 5050 i	CU 5060 i
art. no.	150.012.287	150.012.290	150.012.306	150.012.289
cutter jaw	inclined	inclined	inclined	inclined
EN 13204	BC150F-9.5	BC165I-13.2	BC165K-15.9	CC205K-19.6
NFPA 1936	A6 B5 C6 D6 E6	A7 B7 C6 D7 E8	A8 B8 C7 D9 E9	A9 B9 C9 D9 E9
blade opening	mm 170	170	182	205
max. force	kN/t 549 / 56	764 / 77.9	1389 / 141.6	1765 / 180
weight, ready for use	kg 9.5	13.2	15.9	19.6
round bar	mm 31	36	41	47
integrated lighting / i-Bolt	√ / √	√ / √	√ / √	√ / √

Inclined cutter jaw

- for more ergonomic cutting above waist height or low on the car
- to reduce the effect of tool movement towards the patient or the ground (no unintended leverage)



Integrated LED lighting

- new LED lighting in the carrying handle: no less than six lights with a higher light output. You can start right away, both during the day and at night, without working in your own shadow.



Ergonomic carrying handle

- new ergonomic carrying handle design increases operator comfort in various working positions.
- the Inclined Cutter has one that goes all-around the tool, enabling you to take full advantage of its benefits at all sides of the car.



NCT cutters - Traditional

NCT = **N**ew **C**ar **T**echnology



CU 5030 CL

Specifications	CU 5030 CL	CU 5040	CU 5050	CU 5060
art. no.	150.012.286	150.012.279	150.012.300	150.012.288
cutter jaw	straight	straight	straight	straight
EN 13204	BC150F-9.5	BC165I-13.1	BC165K-15.7	CC205K-19.8
NFPA 1936	A6 B5 C6 D6 E6	A7 B7 C6 D7 E8	A8 B8 C7 D9 E9	A9 B9 C9 D9 E9
blade opening	mm 170	170	182	205
max. force	kN/t 579 / 59	794 / 81	1412 / 144	1793 / 182.8
weight, ready for use	kg 9.5	13.1	15.7	19.8
round bar	mm 31	36	41	47
integrated lighting / i-Bolt	√ / √	√ / √	√ / √	√ / √

NCT blade design - unmatched performance

- pulls material towards the strongest point of the cutter
- superior cutting performance, tested on the latest car models
- optimized cutting edge for long blade life
- saves time: only one cut for wide and deep B-pillars

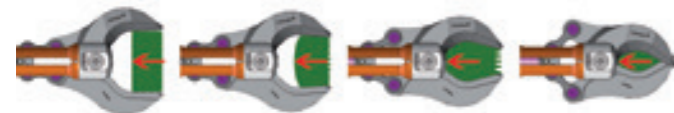

Integrated LED lighting

- new LED lighting in the carrying handle: no less than six lights with a higher light output. You can start right away, both during the day and at night, without working in your own shadow.

Lighter and more ergonomic than ever

- easy to carry and handle, reducing physical burden

i-Bolt Technology

- on all inclined, NCT and GP cutters, except CU 4040 C GP

Traditional bolt construction



- flatter design for better access in narrow spaces

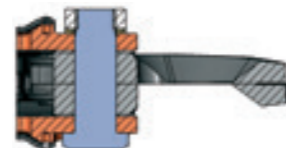

Squeezes ("softer" aluminium) blade holder. Blades are squeezed indirectly only.

i-Bolt construction

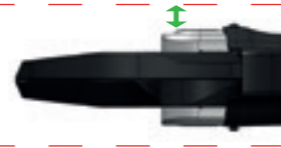

Squeezes blades directly to avoid blade separation, for a superior cutting performance.

GP cutters - General Purpose



CU 5050 GP

Specifications	CU 4007 C	CU 5040 GP	CU 5050 GP
art. no.	150.012.232	150.012.328	158.012.175
EN 13204	AC59B-3.8	CC201I-13.7	CC211J-16.5
NFPA 1936	√	√	√
blade opening	mm 59	280	301
max. force	kN/t 220 / 22.4	794 / 81	1412 / 144
round bar	mm 20	36	41
weight, ready for use	kg 3.8	13.7	16.5
integrated lighting / i-Bolt	-- / √	√ / √	√ / √

The choice is yours

- a Holmatro NCT cutter if your main application is road traffic accidents
- a Holmatro GP cutter if your application can be anything and varies from road traffic accidents to urban search and rescue, industrial accidents, train accidents, etc



CU 5040 GP



CU 4007 C

Spreaders



SP 5240 CL

Specifications	SP 5240 CL	SP 5240	SP 5250	SP 5260	SP 5280	
art. no.	150.012.322	150.012.323	150.012.324	150.012.325	150.012.326	
EN 13204	√ ¹⁾	AS41/725-14.5	AS51/725-15.9	BS62/822-19.6	CS83/662-19.4	
NFPA 1936	√	√	√	√	√	
spreading distance	mm	510	725	725	822	662
max. spreading force	kN/t	131 / 13.4	280 / 28.6	366 / 37.3	522 / 53.2	463 / 47.2
min. spreading force (EN 13204)	kN/t	40 / 4.1	41 / 4.2	51 / 5.2	62 / 6.3	83 / 8.5
max. pulling force	kN/t	47 / 4.8	47 / 4.8	67 / 6.8	82 / 8.4	99 / 10.1
max. squeezing force	kN/t	47 / 4.8	59 / 6	135 / 13.8	127 / 13	159 / 16.2
weight, ready for use	kg	9.6	14.5	15.9	19.6	19.4
Speed Valve / integrated lighting	√ / √	√ / √	√ / √	√ / √	√ / √	

¹⁾ EN 13204 compliant, except for spreading distance

Lighter than ever, no concessions

- optimal performance to weight ratio



Unique Speed Valve in all spreaders

- for quicker reactions



New LED lighting in the carrying handle

- no less than six LED lights with a higher light output
 - you can start your job right away, both during the day and at night, without working in your own shadow



Spreaders - accessories



1



2



3



4



5a



5b

Accessories	For model	Art. No.
1	pulling attachment set PAS 01	SP 5240 CL 150.182.273
	pulling attachment set PAS 02	SP 5240 150.182.274
	pulling attachment set PAS 03	SP 5250 150.182.275
2	pulling chain set PCS 01	SP 5260 150.582.152
	pulling chain set PCS 03	SP 5240 150.582.261
3	pulling chain set in case PCS 02	SP 5280 150.582.021
	pulling chain set in case PCS 04	SP 5240 150.582.020
4	cutting tip set CTS 01	SP 5250 150.006.474
	cutting tip set CTS 02	SP 5260 150.006.466
5a	accessories set in case ACS 01 (2 spreading tips, 2 pulling attachments)	SP 5240 CL 150.182.289
5b	accessory set in case ACS 02 (2 cutting tips, 2 spreading tips, 2 pulling attachments)	SP 5240 150.182.288
	accessory set in case ACS 03 (2 cutting tips, 2 spreading tips, 2 pulling attachments)	SP 5250 150.182.290



Combi tools



CT 5111

Specifications	CT 5111	CT 5111 RH	CT 5117	CT 5117 RH
art. no.	150.012.307	150.012.308	150.012.310	150.012.311
EN 13204	BK48/281-E-8.0	BK48/281-E-7.9	BK28/431-E-8.6	BK28/431-E-8.6
NFPA 1936	A5/B5/C5/D6/E4		A5/B5/C4/D6/E4	
spreading distance	mm	281	431	
max. spreading force	kN/t	457 / 46.6	54 / 5.5	
min. spreading force EN 13204	kN/t	48 / 4.9	28 / 2.9	
max. cutting opening	mm	196	352	
max. cutting force	kN/t	206 / 21	204 / 20.8	
max. squeezing force	kN/t	44 / 4.5	27 / 2.8	
max. pulling force	kN/t	--	30 / 3.1	
round bar	mm	24	24	
weight, ready for use	kg	8.0	7.9	8.6
integrated lighting / i-Bolt/ rotating handle		√/√ / --	-- / √ / √	√/√ / --

Lightweight

- easy to carry and handle, reducing physical burden

360° rotatable, flat foldable carrying handle - RH models

- 11 locking positions for use at any angle



Multifunctional

- cutting, spreading, squeezing and pulling (CT 5117) with one tool

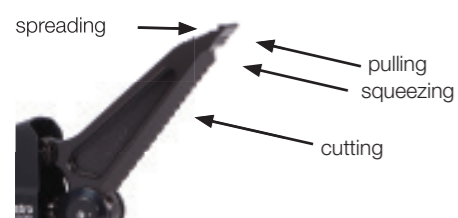

Accessories	For model	Art. No.
1 pulling attachment set PAS 04	CT 5117 CT 5117 RH	150.182.241
2 pulling chain set PCS 05	CT 5117 CT 5117 RH	150.582.548



2

Combi tools

NEW: CT 5160

- Highest force
- Largest spreading distance
- Biggest cutting opening
- Removable spreading tips



CT 5160

Specifications	CT 4120 C	CT 4150 C	CT 5160
art. no.	150.012.141	150.012.099	150.012.330
EN 13204	BK26/268-E-8.7	CK35/360-H-14.2	CK45/468J-17.6
NFPA 1936	√	√	√
spreading distance	mm	268	360
max. spreading force	kN/t	220 / 22.4	211 / 21.5
min. spreading force EN 13204	kN/t	26 / 2.7	35 / 3.6
max. cutting opening	mm	191	229
max. cutting force	kN/t	247 / 25.2	380 / 38.7
max. squeezing force	kN/t	46 / 4.7	76 / 7.7
max. pulling force	kN/t	61 / 6.2	51 / 5.2
round bar	mm	24	32
weight, ready for use	kg	8.7	14.2
integrated lighting / i-Bolt	-- / --	√/√	√/√

Accessories	For model	Art. No.
1 pulling attachment set PAS 05	CT 4120 C	150.582.551
pulling attachment set PAS 06	CT 4150 C	150.582.026
pulling attachment set PAS 07	CT 5160	150.182.078
2 pulling chain set PCS 01	CT 4120 C CT 4150 C	150.582.152
pulling chain set PCS 03	CT 5160	150.582.261
3 pulling attachment and chain set in case PAC 01	CT 4120 C	150.582.028
pulling attachment and chain set in case PAC 02	CT 4150 C	150.582.018
4 accessories set in case ACS 04	CT 5160	150.182.365
5 pulling chain set in case PCS 04	CT 5160	150.582.020



Rams - single and double plunger



RA 4332 C

Specifications	RA 4311 C	RA 4313 C	RA 4315 C	RA 4321 C	RA 4331 C	RA 4322 C	RA 4332 C
art. no.	150.032.042	150.032.043	150.032.044	150.032.045	150.032.046	150.032.041	150.032.047
EN 13204	R100/150-7.6	R100/250-9.0	R100/400-10.9	R161/250-11.1	R161/350-12.6	R161/480-15.4	R161/680-18.3
NFPA 1936	√	√	√	√	√	√	√
spreading force over full stroke	kN / t	100 / 10.2	100 / 10.2	100 / 10.2	161 / 16.4	161 / 16.4	161 / 16.4
(total) spreading stroke	mm	150	250	400	--	--	--
spreading / pulling stroke	mm	--	--	--	250	350	2 x 340
pulling force over full stroke	kN / t	--	--	--	50 / 5.1	50 / 5.1	50 / 5.1
plunger type		single	single	single	single	double	double
retracted/extended length	mm	315/465	415/665	565/965	512/762	612/962	745/1225
weight, ready for use	kg	7.6	9.0	10.9	11.1	12.6	15.4
Speed Valve		√	√	√	√	√	√

Unique Speed Valve in all rams

- for quicker tool placement

sec.

Without Speed Valve

sec.

With Speed Valve

At low pressures, the tools open up significantly quicker.



Accessories	For model	Art. No.
1 accessory kit AS 4300 A (extension pipes 165, 330 and 500 mm)	RA 4321 / 31 C	150.182.269
2 accessory kit AS 4300 B	RA 4321 / 31 C	150.182.296
3 pulling chain set in case PCS 02	RA 4321 / 31 C RA 4322 / 32 C	150.582.021
4 carrying handle RCH 01	RA 4322 / 32 C	150.013.163
rim adapter set, in carrying / storage box (see page 32)	RA 4321 / 31 C RA 4322 / 32 C	150.182.580
extension pipe RAE 01	125 mm RA 4311 / 13 / 15 C	150.181.570
extension pipe RAE 02	225 mm RA 4311 / 13 / 15 C	150.181.571
extension pipe RAE 03	500 mm RA 4311 / 13 / 15 C	150.181.572
connection piece RCP 02	RA 4311 / 13 / 15 C	150.181.573
ram support HRS 22 (NCT) (See page 32)		

Rams - telescopic / Extendo



TR 5350 LP

Specifications	TR 5340 LP	TR 5350 LP	TR 5370 LP	XR 4360 C (Extendo ram)
art. no.	150.032.102	150.032.101	150.032.100	150.032.094
EN 13204	TR217/150-101/125-9.2	TR217/375-101/350-14.6	TR231/450-111/425-16.9	R100/650-13.6 TR100/300-100/350-13.6
NFPA 1936	√	√	√	√
spreading force over full stroke	kN / t	--	--	100 / 10.2
spreading force 1st plunger	kN / t	217 / 22.1	217 / 22.1	--
spreading force 2nd plunger	kN / t	101 / 10.3	101 / 10.3	--
spreading stroke 1st plunger	mm	150	375	450
spreading stroke 2nd plunger	mm	125	350	425
mechanical stroke	mm	--	--	300
hydraulic stroke	mm	--	--	350
(total) spreading stroke	mm	275	725	875
plunger type		telescopic	telescopic	telescopic
retracted/extended length	mm	335 / 610	560 / 1285	635 / 1510
weight, ready for use	kg	9.2	14.6	16.9
Speed Valve / integrated lighting / laser pointer	√ / √ / √	√ / √ / √	√ / √ / √	√ / -- / --

Extendo ram

- with fast mechanical stroke to speed up tool placement



XR 4360 C

Accessories	For model	Art. No.
extension pipe TRE 01	250 mm	TR 5340 LP
extension pipe TRE 02	450 mm	TR 5340 LP
ram support HRS 22 (NCT) (See page 32)		

Integrated laser pointer – patent pending



- to help you hit the right spot in one go, which saves time and is safer for the patient



TR 5340 LP with extension pipes

Greenline battery pump SPU 16 BC



SPU 16 BC

Specifications	SPU 16 BC
art. no.	150.152.689
EN 13204 ¹⁾	STO
NFPA 1936	√
engine	electric, battery-driven: 36 VDC – 940 W
engine	3-stage axial
number of tool connections	1
capacity oil tank	cc 1700
weight, ready for use ²⁾	kg 17.4
continuous operation	per battery 140 minutes during common vehicle extrications 280 minutes unloaded (idle)

¹⁾ EN 13204: STO = Single Tool Operation | ²⁾ including battery, hydraulic oil and coupler

Required Accessories	Art. No.
1 battery BPA 36-1, 36 VDC, 16.2 Ah	150.007.089
2 charger, 110-240 VAC, 50-60 Hz	150.004.048
Accessorie	Art. No.
3 docking station battery SPU 16 BC	150.004.623



All weather proof

- suitable for use at below zero temperatures, down to -20° C
- suitable for use in wet weather conditions

LED lights above the coupler

- easy to locate pump in the dark
- facilitates coupling and uncoupling of hose in the dark



LED battery level indicator

- indicates battery capacity while pump is in use
- when pump is not in use, the battery capacity can be checked by pressing a button

Long running time

- 140 minutes during common vehicle extrications, even with the use of heavy-duty rescue tools
- 70 minutes continuous spread/cut tool use

3-stage pump technology

- higher flow / tool speed in 2nd stage, more control when you need it in 3rd stage

Emission-free

- ideal for powering rescue equipment in confined spaces like tunnels, trains and collapsed buildings
- healthier for rescuers and victims



ECO whisper mode

- power saving and extremely low noise level when tool is not in use

Motor pumps



DPU 31 PC

Specifications	SPU 16 PC	DPU 31 PC
art. no.	150.152.671	150.152.180
EN 13204 ¹⁾	STO	MTO
NFPA 1936	√	√
engine	petrol: 2.1 HP - 1.6 kW	petrol: 3.5 HP - 2.6 kW
pump type	3-stage axial	2 x 2-stage axial pump
number of tool connections	1	2
capacity oil tank	cc 1700	2490
weight, ready for use ²⁾	kg 16.7	24.9

¹⁾ EN 13204: STO = Single Tool Operation, MTO = Multiple Tool Operation

²⁾ Including hydraulic and engine oil, fuel and coupler(s)

ECO-switch

- Electronic engine speed control. In ECO setting, engine speed increases automatically to maximum speed when tool is used
- when tool is not used, engine speed reverts to nominal speed
- minimizes noise and fuel consumption

Extremely lightweight pumps

- can be carried quickly and easily to even the most inaccessible accident locations



Low noise level - both models

- according to EN ISO 11201
- more comfortable for victim and better workplace for rescuer



High noise level
- burden for victims
- difficult to communicate at rescue scene.

Low noise level
- decreased burden for victims
- easy to communicate at rescue scene

3-stage pump technology - SPU 16 PC

- higher flow / tool speed in 2nd stage, more control when you need it in 3rd stage

Lighting above coupler(s)

- easy identification in the dark and facilitates coupling and uncoupling of hoses



Spider Range pumps - SR 10



SR 10 PC 1 E

Specifications	SR 10 PC 1	SR 10 PC 1 E
art. no.	150.152.690	150.152.691
EN 13204 ¹⁾	STO	STO
NFPA 1936	√	√
engine	petrol: 2.1 HP - 1.6 kW	petrol: 2.1 HP - 1.6 kW
pump type	3-stage axial	3-stage axial
number of tool connections	1	1
capacity oil tank	cc 2840	2840
weight, ready for use ²⁾	kg 14.5	15.2

¹⁾ EN 13204: STO = Single Tool Operation

²⁾ including hydraulic and engine oil, fuel and coupler

Large hydraulic oil capacity

- pump can be used with any tool including the biggest rams

ECO mode - SR 10 PC 1 E

- for optimal reduction of noise and fuel consumption
 - less noise means less stress for victims and easier on-scene communication
 - reduced fuel consumption extends the pump's operation time



Hydraulic oil level indicator

- for quick and easy monitoring of oil level from the outside of the pump
 - also on SR 20 (see page 15)

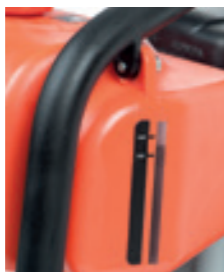

SR 10 - accessories	Art. No.
Quick Fix & Release Bracket (see page 15) ¹⁾	150.062.188
mounting plate pump side	150.062.189
angled mounting plate truck side	150.062.193
LED light Spider range	590.000.343
ECO module SR 10 PC ²⁾	150.182.270

¹⁾ delivered with fastening material

²⁾ to upgrade your existing SR 10 PC 1 pump to an SR 10 PC 1 E

3-stage pump technology

- much higher flow/speed in 2nd stage for quicker rescue operations
 - lower flow/speed in 3rd stage for more tool control

Compact and lightweight

- ergonomic design
 - easy to carry
 - easy to store



Soft-grip carrying handle

- better grip
 - ergonomic design for improved carrying balance: pump easier to carry

Spider Range pumps - SR 20



SR 20 PC 2 E

Specifications	SR 20 PC 2	SR 20 PC 2 E	SR 20 DC 1	SR 20 DC 2
art. no.	150.152.696	150.152.697	150.152.699	150.152.730
EN 13204 ¹⁾	MTO	MTO	STO	MTO
NFPA 1936	√	√	√	√
engine	petrol: 3.0 HP - 2.2 kW	petrol: 3.0 HP - 2.2 kW	electric 230 VAC - 1.1 kW - 50 Hz - 1 Ph	electric: 230 VAC - 1.8 kW - 50 Hz - 1 Ph
pump type	2 x 3-stage axial pump	2 x 3-stage axial pump	3-stage axial pump	3-stage axial pump
number of tool connections	2	2	1	2
capacity oil tank	cc 4340	4340	4340	4340
weight, ready for use ²⁾	kg 22.7 ²⁾	23.4 ²⁾	24.9 ³⁾	34.0 ³⁾

¹⁾ EN 13204: STO = Single Tool Operation, MTO = Multiple Tool Operation | ²⁾ including hydraulic and engine oil, fuel and couplers | ³⁾ including hydraulic oil and coupler(s)

3-stage pump technology

- much higher flow/speed in 2nd stage for quicker rescue operations
 - lower flow/speed in 3rd stage for more tool control

Large hydraulic oil capacity

- pump can be used with any tool including the biggest rams (STO model)
 - enough oil to operate any two rescue tools at the same time (MTO models)

Compact and lightweight

- ergonomic design
 - easy to carry
 - easy to store

ECO mode - SR 20 PC 2 E

- for optimal reduction of noise and fuel consumption
 - less noise means less stress for victims and easier on-scene communication
 - reduced fuel consumption extends the pump's operation time



SR 20 - accessories	Art. No.
Quick Fix & Release Bracket ¹⁾	150.062.188
mounting plate pump side	150.062.190
angled mounting plate truck side	150.062.193
LED light Spider range	590.000.343
ECO module SR 20 PC ²⁾	150.182.271

¹⁾ delivered with fastening material

²⁾ to upgrade your existing SR 20 PC 2 pump to an SR 20 PC 2 E

Quick Fix & Release Bracket (optional)*

- for quick and easy access to the pump in your rescue vehicle
 - saves time during rescue operations
 - saves space in rescue vehicle
 - less physical strain on rescuers when pulling out and putting back the pump
 * not for SR 20 DC 2



Spider Range pumps - SR 31/32



SR 31 DC 2

Specifications	SR 31 PC 2	SR 32 PC 2	SR 31 DC 2	SR 32 DC 2
art. no.	150.152.703	150.152.707	150.152.711	150.152.713
EN 13204 ¹⁾	MTO	MTO	MTO	MTO
NFPA 1936	√	√	√	√
engine	petrol: 3.0 HP - 2.2 kW	petrol: 3.0 HP - 2.2 kW	electric: 230 VAC - 1.8 kW - 50 Hz - 1 Ph	electric: 230 VAC - 1.8 kW - 50 Hz - 1 Ph
pump type	3-stage axial	3-stage axial	2 x 3-stage axial pump	2 x 3-stage axial pump
number of tool connections	2	2	2	2
length of hoses	m	2 x 15	2 x 20	2 x 15
capacity oil tank	cc	4340	4340	4340
weight, ready for use ²⁾	kg	62.0 ²⁾	66.9 ²⁾	70.2 ³⁾

¹⁾ MTO = Multiple Tool Operation | ²⁾ including hydraulic and engine oil, fuel and couplers | ³⁾ including hydraulic oil and couplers

3-stage pump technology

- much higher flow/speed in 2nd stage for quicker rescue operations
- lower flow/speed in 3rd stage for more tool control

Foldable wheels set (optional)

- on W-models (not in table)
- for fast and easy transportation



Foldable handle for hose winding

- saves valuable storage space in your truck
- quick & easy to use: handle folds out and locks in one step



Large hydraulic oil capacity

- enough oil to operate any two tools at the same time, including the biggest rams

Foldable carrying handles

- for easy carrying
- foldable for easy storage

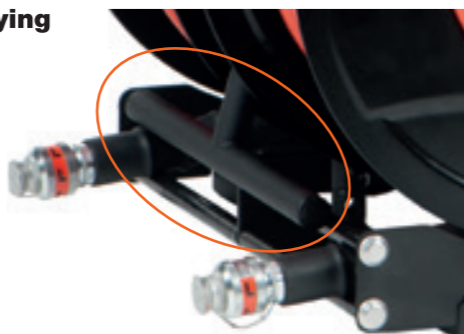

Hydraulic oil level indicator

- for quick and easy monitoring of oil level from the outside of the pump

Spider Range pumps - SR 40/41/42



SR 40 PC 4

Specifications	SR 40 PC 2	SR 40 DC 2	SR 40 YC 2	SR 40 PC 4	SR 40 EC 4
art. no.	150.152.715	150.152.724	150.152.737	150.152.755	150.152.756
EN 13204 ¹⁾	MTO	MTO	MTO	MTO	MTO
NFPA 1936	√	√	√	√	√
engine	petrol: 5.5 HP - 4.1 kW	electric: 230 VAC - 1.8 kW - 50 Hz - 1 Ph	diesel: 4.2 HP - 3.1 kW	petrol: 5.5 HP - 4.1 kW	electric: 400 VAC - 4 kW - 50 Hz - 3 Ph
pump type	3-stage axial pump	2 x 3-stage axial pump	2 x 3-stage axial pump	4 x 3-stage axial pump	4 x 3-stage axial pump
number of tool connections	2	2	2	4	4
capacity oil tank	cc	6340	6340	6340	6340
weight, ready for use ²⁾	kg	37.3 ²⁾	41.0 ³⁾	47.0 ²⁾	54.6 ³⁾

¹⁾ MTO = Multiple Tool Operation | ²⁾ including hydraulic and engine oil, fuel and couplers | ³⁾ including hydraulic oil and couplers

3-stage pump technology

- much higher flow/speed in 2nd stage for quicker rescue operations
- lower flow/speed in 3rd stage for more tool control

Also available with electric start

- Petrol pump S-models (not in table)
- detachable operation panel (240 x 190 x 150 mm) incl. 3m. cable with connector
- including battery; automatically charges when engine runs



ECO mode on SR 40 PC 2 E(S) - not in table

- for optimal reduction of noise and fuel consumption
- less noise means less stress for victims and easier on-scene communication
- reduced fuel consumption extends the pump's operation time

Hydraulic oil level indicator

- for quick and easy monitoring of oil level from the outside of the pump

SR 40 - accessories	Art. No.
LED light Spider range	590.000.343
ECO module SR 40 PC 2 ¹⁾	150.182.272

¹⁾ to upgrade your existing SR 40 PC 2 (S) pump to an SR 40 PC 2 E(S)

Large hydraulic oil capacity

- enough oil to operate any two tools at the same time, including the biggest rams

Also available with hose reels - not in table

- 15 m (41 models) or 20 m (42 models) hoses, only on petrol / electric pumps with 2 connections
- with foldable handle for hose winding: saves valuable storage space in your rescue truck



Other choices to meet your requirements

- simultaneous operation of 2 or 4 tools
- petrol, diesel, electric or petrol with electric start

Pumps - hand / foot / air



PA 18 H 2 C

Hand / Foot pumps	single hose ¹⁾		CORE			
	PA 04 H 2 S	PA 09 H 2 S	PA 09 H 2 C	PA 18 H 2 C	PA 18 F 2 C	HTT 1800 UC
art. no.	150.142.046	150.142.068	150.142.054	150.142.056	150.142.060	150.142.024
number of tool connections ²⁾	1	1	1	1	1	1
number of stages	2	2	2	2	2	3
operation	m	hand	hand	hand	foot	hand
capacity oil tank	cc	410	900	900	1800	1800
weight, ready for use ³⁾	kg	3.5	4.3	4.9	7.7	8.5

¹⁾ for use with single acting tools only | ²⁾ EN 13204: STO = Single Tool Operation | ³⁾ including hydraulic oil and coupler



PA 09 H 2 S



HTT 1800 UC

Pump - air driven	AHS 1400 FDUC
art. no.	150.152.584
number of tool connections ¹⁾	1
max. air pressure	bar
capacity oil tank	cc
weight, ready for use ²⁾	kg

¹⁾ EN 13204: STO = Single Tool Operation | ²⁾ including hydraulic oil and coupler



AHS 1400 FDUC

Hoses / Hose reels



CORE hoses 5 m.

Hoses - CORE						Hoses - single			
colours ¹⁾									
length	m	5	10	15	20	1	2	3	5
weight ²⁾	kg	2.5	4.7	6.9	9.1	1.0	1.3	1.6	2.3

¹⁾ each length available in the colours indicated | ²⁾ weight with couplers and filled with oil

**safety ratio all hoses
4:1 = 2880 bar**

Hose reels - CORE		single		double		electric rewind - left or right version	
colours ¹⁾							
length	m	15	20	2 x 15	2 x 20	25	30
weight ²⁾	kg	17.1	19.3	34.5	38.9	38.0	40.5

¹⁾ each length available in the colours indicated | ²⁾ weight inclusive hose with couplers and filled with oil

Foldable handle for hose rolling on single and double hose reels

- to save valuable storage space in your truck
- quick & easy to use: handle folds out and locks in one step



single hose reel



double hose reel

Self-contained rescue tools

Cordless NCT cutters - Inclined

NCT = **N**ew **C**ar **T**echnology

NEW! Inclined Cutter

with 30° angled jaw (i models)

- Improved ergonomics
- Maximized working space

Explanation on page 2



GCU 5050 i EVO 3

Specifications		GCU 5030 i CL EVO 3	GCU 5040 i EVO 3	GCU 5050 i EVO 3	GCU 5060 i EVO 3
art. no.		150.052.109	150.052.111	150.052.113	150.052.115
cutter jaw		inclined	inclined	inclined	inclined
max. force	kN/t	549 / 56	764 / 77.9	1389 / 141.6	1765 / 180
blade opening	mm	170	170	182	205
weight, ready for use (incl. battery)	kg	15.2	19	21.6	25.4
round bar	mm	31	36	41	47
integrated lighting / i-Bolt		√ / √	√ / √	√ / √	√ / √

Unmatched performance, ultimate freedom. Go to holmatro.com/evo3

Self-contained

- for optimal freedom of movement
- rapid deployment: simply press the start button and start working

Inclined cutter jaw

- for more ergonomic cutting above waist height or low on the car
- to reduce the effect of tool movement towards the patient or the ground (no unintended leverage)



Excellent cutting performance on new cars

- NCT blade design: U-shaped blades pull even the widest material into the cutting recess, allowing it to be cut at the strongest point of the cutter



i-Bolt technology

- equipped with i-Bolt which squeezes the blades together directly (thus more tightly) for less blade separation and an improved cutting performance

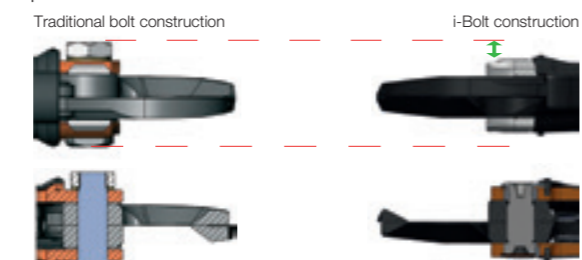

Squeezes ("softer" aluminium) blade holder. Blades are squeezed indirectly only.

Squeezes blades directly to avoid blade separation, for a superior cutting performance.

Self-contained rescue tools

Cordless NCT cutters - Traditional

NCT = **N**ew **C**ar **T**echnology



GCU 5030 CL EVO 3

Specifications		GCU 5030 CL EVO 3	GCU 5040 EVO 3	GCU 5050 EVO 3	GCU 5060 EVO 3
art. no.		150.052.108	150.052.110	150.052.112	150.052.114
cutter jaw		straight	straight	straight	straight
max. force	kN/t	579 / 59	794 / 81	1412 / 144	1793 / 182.8
blade opening	mm	170	170	182	205
weight, ready for use (incl. battery)	kg	15.1	18.8	21.4	25.3
round bar	mm	31	36	41	47
integrated lighting / i-Bolt		√ / √	√ / √	√ / √	√ / √

Required Accessories (for all models)		Art. No.
1	battery BPA 283 (3.0 Ah)	150.005.823
	battery BPA 285 (5.0 Ah)	150.006.208
Accessories (for all models)		Art. No.
2	battery charger BCH1 (220 - 240 VAC)	150.182.208
	battery charger BCH2 (100 - 120 VAC)	150.182.209
	battery car charger BCH3, 12-24 VDC	150.182.286
3	mains power connector BMC1 (220 - 240 VAC)	150.182.206
	mains power connector BMC2 (100 - 120 VAC)	150.182.207
4	battery pouch	150.182.214
5	carrying strap	150.182.249



Self-contained rescue tools

Cordless spreaders



GSP 5240 CL EVO 3

Specifications		GSP 5240 CL EVO 3	GSP 5240 EVO 3	GSP 5250 EVO 3
art. no.		150.052.116	150.052.117	150.052.118
spreading distance	mm	510	725	725
max. spreading force	kN/t	131 / 13.4	280 / 28.6	366 / 37.3
min. spreading force (EN 13204)	kN/t	40 / 4.1	41 / 4.2	51 / 5.2
max. pulling force	kN/t	47 / 4.8	47 / 4.8	67 / 6.8
max squeezing force	kN/t	47 / 4.8	59 / 6	135 / 13.8
weight, ready for use (incl. battery)	kg	15.4	20.3	21.7
integrated lighting		√	√	√

Unmatched performance, ultimate freedom. Go to holmatro.com/evo3

Effective profile on the spreading tips

- perfect grip in every situation



Use in all weather conditions

- suitable for use in all weather conditions, also in the case of (extreme) precipitation and temperatures down to -20° C.



Emission-free

- no emissions, so healthier for rescuers and victims: ideal for use in confined and/or underground spaces.



Advanced battery technology

- lithium-ion technology combines a long battery life with high capacity for maximum operational use.



Required Accessories (for all models)		Art. No.	
1	battery BPA 283 (3.0 Ah)	150.005.823	
	battery BPA 285 (5.0 Ah)	150.006.208	
Accessories (for all models)		Art. No.	
2	battery charger BCH1 (220 - 240 VAC)	150.182.208	
	battery charger BCH2 (100 - 120 VAC)	150.182.209	
	battery car charger BCH3, 12-24 VDC	150.182.286	
3	mains power connector BMC1 (220 - 240 VAC)	150.182.206	
	mains power connector BMC2 (100 - 120 VAC)	150.182.207	
4	battery pouch	150.182.214	
5	carrying strap	150.182.249	
Accessories		For model	Art. No.
6	pulling attachment set PAS 01	GSP 5240 CL	150.182.273
	pulling attachment set PAS 02	GSP 5240 GSP 5250	150.182.274
7	pulling chain set PCS 01	GSP 5240 CL	150.582.152
		GSP 5240	
		GSP 5250	
8	pulling chain set in case PCS 02	GSP 5240 CL GSP 5240 GSP 5250	150.582.021
9	cutting tip set CTS 01	GSP 5240	150.006.474
		GSP 5250	
10a	accessories set in case ACS 01 (2 spreading tips, 2 pulling attachments)	GSP 5240 CL	150.182.289
10b	accessory set in case ACS 02 (2 cutting tips, 2 spreading tips, 2 pulling attachments)	GSP 5240 GSP 5250	150.182.288



Self-contained rescue tools

Cordless combi tools



GCT 5111 EVO 3

Specifications		GCT 4120 EVO 3	GCT 4150 EVO 3	GCT 5111 EVO 3	GCT 5117 EVO 3	GCT 5160 EVO 3
art. no.		150.052.105	150.052.106	150.052.099	150.052.102	150.052.098
spreading distance	mm	268	360	281	431	468
max. spreading force	kN/t	220 / 22.4	211 / 21.5	457 / 46.6	54 / 5.5	1367 / 139.4
min. spreading force (EN 13204)	kN/t	26 / 2.7	35 / 3.6	48 / 4.9	28 / 2.9	44.5 / 4.5
max. cutting opening	mm	191	229	196	352	394
max. cutting force	kN/t	247 / 25.2	380 / 38.7	206 / 21	204 / 20.8	929 / 94.7
max. squeezing force	kN/t	46 / 4.7	76 / 7.7	44 / 4.5	27 / 2.8	87.9 / 9
max. pulling force	kN/t	61 / 6.2	51 / 5.2	--	30 / 3.1	105 / 10.7
weight, ready for use (incl battery)	kg	14.6	19.6	13.7	14.4	23.3
round bar	mm	24	32	24	24	40
integrated lighting / i-Bolt		√ / --	√ / √	√ / √	√ / √	√ / √

Unmatched performance, ultimate freedom. Go to holmatro.com/evo3

Cordless

- no pump and hose(s) needed
- battery quickly rechargeable and replaceable

Multifunctional

- a single piece of equipment for cutting, spreading, squeezing and pulling



Required Accessories (for all models)		Art. No.	
1	battery BPA 283 (3.0 Ah)	150.005.823	
	battery BPA 285 (5.0 Ah)	150.006.208	
Accessories (for all models)		Art. No.	
2	battery charger BCH1 (220 - 240 VAC)	150.182.208	
	battery charger BCH2 (100 - 120 VAC)	150.182.209	
	battery car charger BCH3, 12-24 VDC	150.182.286	
3	mains power connector BMC1 (220 - 240 VAC)	150.182.206	
	mains power connector BMC2 (100 - 120 VAC)	150.182.207	
4	battery pouch	150.182.214	
5	carrying strap	150.182.249	
6	carrying / backpack harness	150.553.115	
Accessories		For model	Art. No.
7	carrying/storage bag	GCT 5111 EVO 3	150.182.228
		GCT 5117 EVO 3	
		GCT 4120 EVO 3	
8	pulling attachment set PAS 04	GCT 5117 EVO 3	150.182.241
		GCT 4120 EVO 3	150.582.551
		GCT 4150 EVO 3	150.582.026
		GCT 5160 EVO 3	150.182.078
9	pulling chain set PCS 05	GCT 5117 EVO 3	150.582.548
		GCT 4120 EVO 3	150.582.152
		GCT 4150 EVO 3	
10	pulling attachment and chain set in case PAC 01	GCT 4120 EVO 3	150.582.028
		GCT 4150 EVO 3	150.582.018
11	accessories set in case ACS 04	GCT 5160 EVO 3	150.182.365
12	pulling chain set in case PCS 04	GCT 5160 EVO 3	150.582.020



Self-contained rescue tools

Cordless rams



GTR 5340 LP EVO 3

Specifications		GRA 4321 EVO 3	GRA 4331 EVO 3	GTR 5340 LP EVO 3	GTR 5350 LP EVO 3
art. no.		150.052.119	150.052.120	151.000.092	151.000.061
spreading force over full stroke	kN / t	161 / 16.4	161 / 16.4	--	--
spreading force 1st plunger	kN / t	--	--	217 / 22.1	217 / 22.1
spreading force 2nd plunger	kN / t	--	--	101 / 10.3	101 / 10.3
spreading stroke 1st plunger	mm	--	--	150	375
spreading stroke 2nd plunger	mm	--	--	125	350
(total) spreading / pulling stroke	mm	250	350	275	725
pulling force over full stroke	kN / t	50 / 5.1	50 / 5.1	--	--
retracted / extended length	mm	591 / 841	691 / 1041	335 / 610	560 / 1285
weight, ready for use (incl battery)	kg	18.4	19.9	17.6	24.6
integrated lighting / laser pointer		√ / --	√ / --	√ / √	√ / √

Unmatched performance, ultimate freedom. Go to holmatro.com/evo3

High performance

- high spreading force of 161 kN on both models

Powered by lithium-ion battery technology

- combines a long battery life with high capacity for maximum operational use

- LED indicator shows battery capacity



Required Accessories (for all models)		Art. No.		
1	battery BPA 283 (3.0 Ah)	150.005.823		
	battery BPA 285 (5.0 Ah)	150.006.208		
Accessories (for all models)		Art. No.		
2	battery charger BCH1 (220 - 240 VAC)	150.182.208		
	battery charger BCH2 (100 - 120 VAC)	150.182.209		
	battery car charger BCH3, 12-24 VDC	150.182.286		
3	mains power connector BMC1 (220 - 240 VAC)	150.182.206		
	mains power connector BMC2 (100 - 120 VAC)	150.182.207		
4	battery pouch	150.182.214		
Accessories		For model	Art. No.	
5	accessory kit AS 4300 A in carrying / storage box (extension pipes 165, 330 and 500 mm)	GRA 4321 / 31 EVO 3	150.182.269	
		GRA 4331 / 31 EVO 3		
6	accessory kit AS 4300 B in carrying / storage box	GRA 4321 / 31 EVO 3	150.182.296	
7	pulling chain set in case PCS 02	GRA 4321 / 31 EVO 3	150.582.021	
8	extension pipe TRE 01	250 mm	GTR 5340 LP	150.182.337
9	extension pipe TRE 02	450 mm	GTR 5340 LP	150.182.336
rim adapter set, in carrying / storage box (see page 32)			150.182.580	
ram support HRS 22 (NCT) (see page 32)				



Self-contained rescue tools

Hand-operated tools



HCT 5111

Self-contained rescue tools	Combi tools					Power Wedge
	HCT 4120 ¹⁾	HCT 5111	HCT 5111 RH	HCT 5117 ²⁾	HCT 5117 RH ²⁾	HPW 4624
art. no.	150.012.146	150.012.314	150.012.315	150.012.317	150.012.318	150.062.132
EN 13204 classification	BK26/268-E-10.8	BK48/281-E-8.8	BK48/281-E-8.7	BK28/431-E-9.5	BK28/431-E-9.4	--
spreading	mm 268	281	281	431	431	--
max. spreading force	kN / t 220 / 22.4	457 / 46.6	457 / 46.6	54 / 5.5	54 / 5.5	235 / 24
min. spreading force (EN 13204)	kN / t 26 / 2.7	48 / 4.9	48 / 4.9	28 / 2.9	28 / 2.9	--
max. cutting opening	mm 191	196	196	352	352	--
max. cutting force	kN / t 247 / 25.2	206 / 21	206 / 21	204 / 20.8	204 / 20.8	--
max. squeezing force	kN / t 46 / 4.7	44 / 4.5	44 / 4.5	27 / 2.8	27 / 2.8	--
max. pulling force	kN / t 61 / 6.2	--	--	30 / 3.1	30 / 3.1	--
min. insertion height	mm --	--	--	--	--	6
max. lifting height	mm --	--	--	--	--	51
weight, ready for use	kg 10.8	8.8	8.7	9.5	9.4	11.8
round bar	mm 24	24	24	24	24	--
integrated lighting / i-Bolt / rotating handle	-- / -- / --	√ / √ / --	-- / √ / √	√ / √ / --	-- / √ / √	√ / -- / --

¹⁾ for accessories see CT 4120 C on page 9 | ²⁾ for accessories see CT 5117 (RH) on page 8



HCT 4120



HPW 4624

Self-contained with integrated 2-stage pump

- for optimal freedom of movement
- rapid deployment: simply fold out the pump handle and start pumping

Pump handle foldable and rotatable

- easy carrying and storage
- can be used in any position
- also easy to use in confined spaces

360° rotatable, flat foldable carrying handle

- 11 locking positions for use at almost any angle: HCT 5111 / 5117 RH



Various rescue tools

Aluminium jacks	HLJ 50 A 6	HLJ 50 A 10
art. no.	150.112.060	150.112.059
lifting capacity	kN / t 510 / 52	510 / 52
closed height	mm 150	196
stroke	mm 61	104
weight, ready for use	kg 7.0	8.7



Power Wedge	PW 5624
art. no.	150.062.228
min. insertion height	mm 6
max. lifting height	mm 51
max. spreading force	kN / t 235 / 24
weight, ready for use	kg 9.2



- creates space for spreader or high-pressure lifting bag

Example of progressive lifting operation



Power Wedge creates opening for lifting bag (see page 36)



Lifting bag is inflated and backed up by stabilization blocks



This creates space for lifting jack

Toe jack	TJ 3610
art. no.	150.012.049
max. capacity on saddle	kN / t 118 / 12
max. capacity on toe	kN / t 98 / 10
lifting height / plunger stroke	mm 250
closed height	mm 448
min. insertion height toe	mm 56
weight, ready for use	kg 20.5

TJ 3610



Various rescue tools

Concrete crusher		CC 23
art. no.	150.012.295	
max. opening	mm	230
max. crushing force	kN / t	113 / 11.5
shape of tip	pointed	
weight ready for use	kg	19.1

- heavy-duty: designed to quickly break away large, thick pieces of concrete
- limited dust: supports a clear view at the rescue scene
- no vibrations: prevents risk of secondary collapse
- ideal to use in combination with mini cutter for cutting re-bar
- more silent than use of rescue saw: only pump produces sound



- Designed for heavy-duty work
- The crusher hardly generates any dust



A perfect combination: crushing concrete with the CC 23 and cutting re-bar with mini cutter CU 4007 C or SMC 5006

Pipe squeezer		HPS 60 AU
art. no.	150.182.024	
max. squeezing force	kN / t	147 / 15
max. outside ø pipe	mm	60
max. wall thickness pipe	mm	4.0
weight, ready for use	kg	8.6



HPS 60 AU



Cable cutters	Steel cable			Electric cable		
	HWC 16 R	HWC 25 R	HWC 32 R	HCC 85 R	HCC 100 R	
art. no.	150.012.266	150.012.267	150.012.268	150.012.269	150.012.270	
capacity	kN / t	52 / 5.3	146 / 14.9	249 / 25.4	49 / 5	87 / 8.9
max. jaw opening	mm	20	50	32	85	100
capacity steel cable 6 x 19	Ø mm	20	30	32	-	-
capacity solid steel	Ø mm	13	19	25	-	-
capacity ground cable	Ø mm	18	50	32	50	75
capacity telephone cable	Ø mm	-	-	-	85	100
weight, ready for use	kg	2.0	8.4	8.9	6.8	12.7



HWC 16 R



HWC 32 R



HCC 85 R

Various rescue tools

Special Materials Cutter		SMC 5006
art. no.	150.012.320	
blade opening	mm	25
max. cutting force	kN / t	193 / 19.7
cutting capacity ¹⁾	mm	Ø 20
weight, ready for use	kg	6.5

¹⁾ steel hardness 75 HRb



Mini cutter HMC 8 U - single acting		art. no.
1	with fixed coupler	150.012.025
2	with 30 cm pigtail hose; in synthetic case	150.012.026
3	360° rotation elbow and 30 cm pigtail hose; in synthetic case	150.012.027
4	with 360° rotation elbow and handpump PA 04 H 2 S mounted with 2m. hose; in synthetic case	150.142.070
max. cutting force	kN / t	79 / 8.1
depth / width of jaw	mm	40 / 40
weight, ready for use	kg	3.0



1



4



3



Door openers	HDR 50 ¹⁾	HDO 100 ²⁾
	art. no.	150.062.016
max. spreading force	kN / t	47 / 4.8
max. pushing force	kN / t	51 / 5.2
min. / max. width	mm	710 / 1310
stroke	mm	-- / --
weight, ready for use	kg	11.0
		6.7

¹⁾ for pump (HTT 1250 ST) and hose, ask your local dealer

²⁾ with rotating hose connection and handle, delivered in synthetic carrying / storage box; also available with 30 cm pigtail hose, without handle (150.062.008)



HDR 50

HDO 100



Rescue assist tools

Ram support		HRS 22	HRS 22 NCT
art. no.		150.181.011	150.003.105
max. load	kN / t	235 / 24	235 / 24
weight	kg	7.7	14.9

- suitable for every door sill: HRS 22 NCT for wider door sills and B-pillars of new model cars
- various positioning bars for different ramming angles
- NCT version with teeth providing grip and profiled bars to prevent tilting of the ram



Rim adapter set	
art. no.	150.182.580
weight, incl. case	kg 12.4

- can be used with rams RA 4321-22 C / RA 4331-32 C
- rescuer does not have to move under the vehicle
- can also be used to push away the steering column of a truck



Chocks & blocks			
set A		set B	
art. no.	150.562.010	art. no.	150.562.004
2 x step chock		2 x lock block low	
2 x wedge small		2 x lock block medium	
2 x wedge large		2 x lock block high	
		2 x wedge small	
		2 x wedge large	

- made of recycled polyethylene, water- and oil-resistant
- virtually indestructible, longer lifespan than wood
- non-slip interlocking profile



Tool stations			
art. no.		150.182.043	150.182.044
dimensions (L x W)	cm	200 x 150	250 x 200
weight	kg	2.3	3.7

- durable, water- and dirt-repellent PVC coated polyester
- foldable, so easy to carry and store

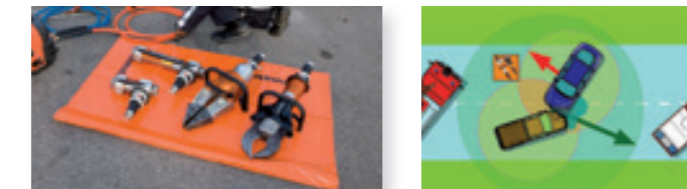

Protection shield			
art. no.		150.182.045	
dimensions (L x W)	mm	900 x 500	
weight	kg	2.9	

- ensures optimal safety for the victim
- made of thick yet flexible PVC material
- transparent for continuously monitoring of the victim
- with 4 handles to hold in any position



Rescue support bag	
art. no.	150.182.155
Consisting of:	tyre deflator, seatbelt cutter, trim removal tools, window punch, flexible steel rule, marker pen, mini LED torch, multi-cutter, waist and thigh strap



Rescue assist tools

V-Strut		
art. no.		150.062.158
max. axial load	kN / t	16 / 1.6
closed length	mm	1080
number of stroke steps		24
stroke step size	mm	30
total stroke	mm	720
extended length	mm	1800
weight	kg	7.9

- vehicle stabilization strut with integrated head, base plate and tensioning belt with hook and ratchet mechanism
- all-in-one solution, no loose parts that may get lost
- ready for immediate use
- unique auto-lock system
- fast set-up in just 15 seconds



Glass-Master		
art. no.		150.182.060
weight	kg	1.0

- delivered including a window punch and mounting clips



Airbag Protection Cover Secunet III		
art. no.		350.182.089
weight	gr	250

- easy to install, within seconds
- for all passenger cars, modern vans, heavy goods vehicles and buses
- in synthetic storage box with wall-mounting bracket



Sharp Edge Protection Covers		SEP 5	SEP 10
art. no.		150.581.676	150.581.677
	dimensions cm	weight kg	contents
cover with Velcro	26 x 30	0.18	2 x
blanket with magnets	60 x 60	0.52	2 x
	150 x 60	1.20	1 x

- wear-resistant, fire-retardant polyester, water-repellent
- blankets with magnets for instant attachment to a vehicle
- washable (magnets are removable)



Safetypen		
art. no.		350.182.088
weight	g	65

- combination of window punch and seatbelt cutter
- tested on 10 mm thick car windows
- ultra sharp cutting edge



Extraction gloves			
art. no.	size	art. no.	size
590.000.514	6 / XS	590.000.518	10 / XL
590.000.515	7 / S	590.000.694	11 / 2XL
590.000.516	8 / M	590.000.695	12 / 3XL
590.000.517	9 / L		



PowerShore

Struts with hydraulic cylinder - 100 kN / 10.1 t						Struts with pneumatic cylinder - 4 kN / 0.4 t					
model	art. no.	locking system	retracted length mm	stroke mm	weight kg	model	art. no.	locking system	retracted length mm	stroke mm	weight kg
HS 1 Q 5 FL	150.011.547	Auto-lock	632	252	10.3	AS 3 Q 5 FL	150.011.546	Auto-lock	632	252	8.4
HS 1 Q 10 FL	150.011.536	Auto-lock	1092	252	13.0	AS 3 Q 10 FL	150.011.545	Auto-lock	1092	252	11.2
HS 1 L 5+	150.011.543	Locknut	575	252	9.2	AS 3 L 5+	150.011.532	Locknut	575	252	7.3
HS 1 L 10+	150.011.537	Locknut	1035	252	11.9	AS 3 L 10+	150.011.531	Locknut	1035	252	10.1

Auto-lock: plunger with automatic locking mechanism that locks in steps of 9 mm. Retracting the plunger is only possible after releasing the locking mechanism.

Locknut: plunger with thread and Locknut. When the plunger is extended the Locknut can be secured.



HS 1 L 5+



AS 3 Q 5 FL

Operation hydraulic PowerShore

- handpump, weight ready for use 8.9 kg



PA 09 H 2 S 10

Operation pneumatic PowerShore

- single or double control unit, pressure reducer, air hoses and air bottle



Manual (mechanical) struts

model	art.no.	locking system	retracted length mm	stroke mm	weight kg
MS 2 L 2 +	150.011.538	Thread	250	127	2,7
MS 2 L 5 +	150.011.533	Locknut	575	250	6.7

Thread: plunger with thread. When the plunger is extended the thread is self-retaining.

Locknut: plunger with thread and a Locknut. When the plunger is extended the Locknut can be secured.



MS 2 L 2+

Extensions / connector

model	art. no.	extension mm	colour code	weight kg
SX 1	150.011.501	125	white	1.5
SX 2	150.011.502	250	blue	1.9
SX 5	150.011.503	500	yellow	2.8
SX 10	150.011.504	1000	green	4.9
SX 15	150.011.506	1500	red	6.4
FX 1	150.011.505	-		1.4

Connector FX1: with female snap-lock system on both sides. To connect the male end of an extension with one of the heads. In this way it is possible to make a fixed shore without the use of a strut.



SX 2

One lightweight shoring and lifting system for every rescue situation



- vehicle extrication



- trench rescue



- heavy vehicle rescue



- urban search and rescue

See also separate PowerShore brochure and www.holmatro.com for various advisory sets

PowerShore

Accessories					
Flat head		V-block head small		Adjustable hook wrench	
Flat head with nailing plate		V-block head large		Rope with carabine hook	
Tilting head; Max. angle 45° in all directions		Cone head		Rubber anti-roll block	
Tilting head with nailing plate; Max. angle 45° in all directions		Cross head		Storage / carrying bag for accessories	
Beam support head; 150 mm; with nailing holes		Pointed head		Storage / carrying bag for struts and extensions	
Beam support head; 100 mm; with nailing holes		Base support plate; can support 3 swivel heads		2-way block; to support 2 tilting heads	
L-support head; with nailing holes		Trench support plate to support 2 swivel heads		3-way swivel head; contains 3 integrated swivel heads for use with up to 3 shoring lines in various directions	
Swivel head; can be placed in almost any position and against each other for mutual support		Tensioning belt; load 10 kN			

Snap-lock system

- all items can be connected within seconds



Shoring at various angles possible

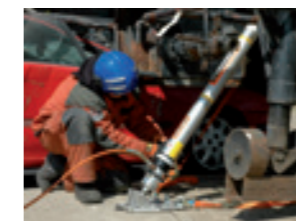

Reflective colour coding of extensions indicating length



10.1 t hydraulic lifting capacity



Lightweight

- easy to carry
- easy to assemble and quick to position



Lifting bags

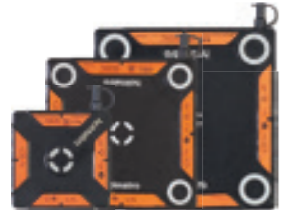

HLB 2, 6, 8



HLB 11, 16, 21, 31, 38



HLB 53, 63, 85, 96

Lifting bags - max. working pressure 12 bar					
model	art. no.	max. effective lifting force kN/t	max. inflation height mm	dimensions (L x W x H) mm	weight kg
HLB 2	350.321.021	21 / 2.1	94	200 x 160 x 22	0.7
HLB 6	350.321.022	55 / 5.6	141	285 x 245 x 22	1.6
HLB 8	350.321.023	82 / 8.4	179	335 x 295 x 22	2.1
HLB 11	350.321.025	110 / 11.2	207	403 x 325 x 25	3.2
HLB 16	350.321.026	155 / 15.8	236	467 x 390 x 25	4.5
HLB 21	350.321.027	210 / 21.4	266	517 x 440 x 25	5.6
HLB 31	350.321.028	306 / 31.2	321	608 x 530 x 27	8.6
HLB 38	350.321.030	370 / 37.7	352	662 x 585 x 27	10
HLB 53	350.321.031	520 / 53	411	767 x 690 x 27	15
HLB 63	350.321.032	620 / 63.2	456	827 x 750 x 27	17
HLB 85	350.321.034	855 / 87.2	550	948 x 870 x 27	23
HLB 96	350.321.033	940 / 95.9	565	987 x 910 x 27	25



Accessories		
item	description	article number
1	control unit HDC 12	350.182.095
2	pressure reducer PRV 12	350.182.100
3	air bottle 300 bar	350.581.096
4	shut-off hose SOH 12	350.182.096
5	slider pads set (3 pieces) *	151.000.180
6	lifting eyes set (2 pieces) **	350.182.129
7	air control set ACS 12	350.182.125
8	connection piece	350.582.430
9	air adapter set AAS 12	151.000.223

* Standard for models HLB 11 and up
 ** Optional for models HLB 31 and up

Air hoses			
item	description	length	article number
10	air hose AH 5 Y	5 m	350.570.022
11	air hose AH 5 B	5 m	350.570.023
12	air hose AH 5 O	5 m	350.570.030
13	air hose AH 10 Y	10 m	350.570.027
14	air hose AH 10 B	10 m	350.570.026
15	air hose AH 10 O	10 m	350.570.031

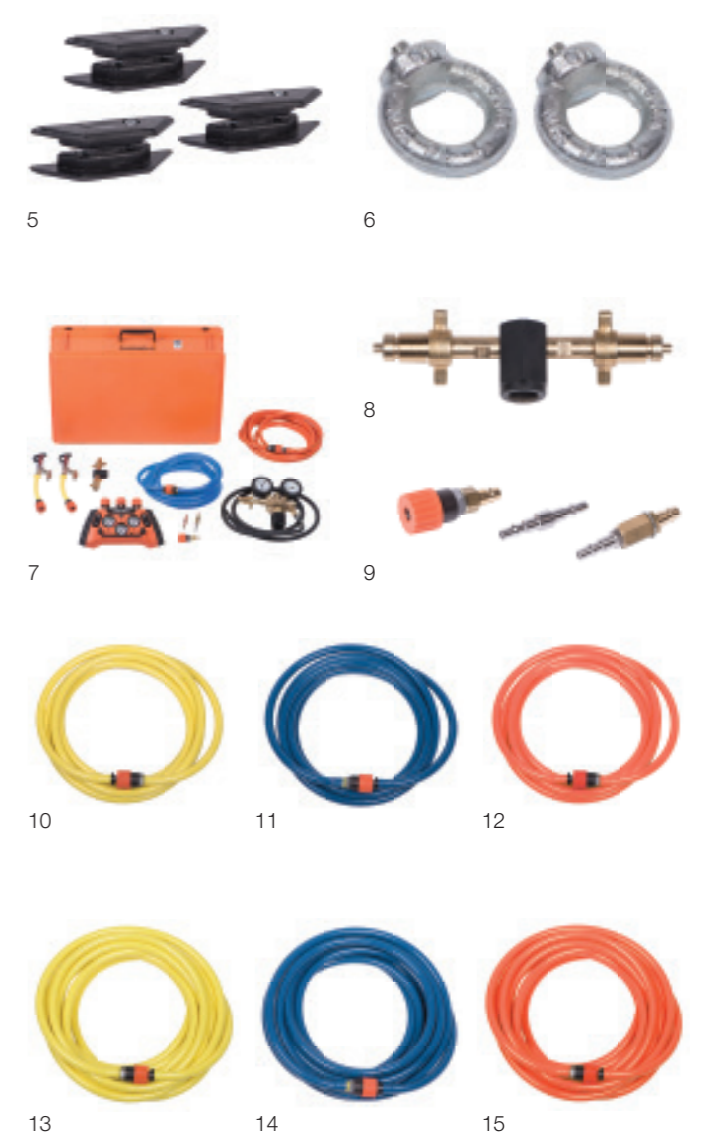

Lifting bags / Leak sealing systems



Lifting bags - max. working pressure 0.5 bar					
model	art. no.	lifting capacity (a pair) t	dimensions single bag (L x W) mm	weight (a set*) kg	height deflated / inflated mm
LAB 4 UN	350.512.204	3.6	600 x 600	27.0	60 / 580
LAB 6 UN	350.512.206	5.8	750 x 750	34.0	60 / 580
LAB 9 UN	350.512.209	8.2	900 x 900	41.0	60 / 580
LAB 16 UN	350.512.216	14.6	1200 x 1200	65.0	60 / 580

* Each set consists of		
item	contents	description
1	1	storage bag
2	2	lifting bag (of equal capacity)
3	1	pressure reducer
4	2	low pressure hose
5	1	double control unit
6	1	repair kit



Leak sealing system		HVSP 250 U
art. no.		360.302.011
working pressure	bar	6
dimensions sealing pad (L x W)	mm	600 x 390
dim. sealing compartment (L x W)	mm	250 x 50
weighth ready for use	kg	5.3



Tank sealing system		HLS 12
art. no.		350.582.061
working pressure	bar	1.5
capacity lifting bag* at 1.5 bar	t	2



* lifting bag HLB 16 to be ordered separately, see page 36

HOLMATRO OFFICES AND DEALERS

All over the world

Thanks to our worldwide sales and service network there's always a Holmatro representative nearby, ready to assist you!

Find your nearest Holmatro representative on holmatro.com



Holmatro Netherlands
Raamsdonksveer,
The Netherlands
T +31 (0) 162 58 92 00

Holmatro USA
Glen Burnie MD,
USA
T 410-768-9662

Holmatro China
Suzhou, Jiangsu Province
China
T +86 (512) 6380 7060

Holmatro UK
Nottingham,
United Kingdom
T +44 (0) 115-9738590

Holmatro Poland
Warszawa,
Poland
T +48 (22) 76 10 404

www.holmatro.com

 Holmatro Rescue World

 @HolmatroRescue

 holmatrorescue

 HolmatroRescue